

ALL PUBLIC AREAS TO BE USED FOR SALE AND CONSUMPTION OF ALCOHOL, PERFORMANCE OF PLAYS AND DANCE, PUBLIC ENTERTAINMENT INCLUDING BOXING OR WRESTLING AND PROVISION OF FACILITIES, LIVE AND RECORDED MUSIC, FILMS AND LATE NIGHT REFRESHMENT UNLESS OTHERWISE NOTED.

Notes
 THESE DRAWINGS HAVE BEEN PRODUCED FROM LAYOUT DRAWINGS WHOLLY OWNED AND PROVIDED BY THE CLIENT.
 MJC CONSULTING DO NOT GUARANTEE THE ACCURACY OF THE LAYOUTS AS THE BASE DRAWINGS HAVE BEEN PREPARED BY OTHERS.
 THESE DRAWINGS ARE LAYOUT DRAWINGS ONLY TO INDICATE THE FOLLOWING INFORMATION:
 1. APPROXIMATE INDICATIVE FLOOR LAYOUTS.
 2. CERTAIN DETAILS RELATING TO FIRE DETECTION.
 3. STAIRCASE HEIGHTS.
 FFL 100.06 IS THE DATUM LEVEL ON THE STAGE IN METRES. WHERE LEVELS ARE NOTED THESE ARE INDICATIVE APPROXIMATE LEVELS ABOVE OR BELOW THE DATUM LEVEL ON STAGE AT THE LINE OF THE SAFETY CURTAIN ON THE STAGE CENTERLINE.

STAIRCASE KEY			
STAIR REF	No OF RISERS	HEIGHT OF RISERS (mm)	TOTAL RISE (mm)
ST01	6	170	1020
ST02	21	245	5145
ST03	3	125	375
ST04	8	185	1480
ST05	3	170	510
ST06	33	175	5775
ST07	4	195	780
ST08	19	190	3610
ST09	2	165	330
ST10	6	190	1140
ST11	7	185	1295
ST12	5	170	850
ST13	3	205	615
ST14	2	135	270
ST15	2	145	290
ST16	14	170	2380
ST17	2	1 @ 140 1 @ 180	320
ST18	19	130	2470
ST19	22	130	2860
ST20	3	200	600
ST21	2	1 @ 140 1 @ 180	320
ST22	2	165	370
ST23	11	165	1815
ST24	6	175	1050
ST25	3	115	345
ST26	2	125	250
ST27	8	180	1440
ST28	2	1 @ 160 1 @ 145	305
ST29	72	170	12240
ST30	17	180	3060
ST31	2	160	320
ST32	2	1 @ 150 1 @ 180	330
ST33	16	160	2560
ST34	8	160	1280
ST35	11	150	1650
ST36	7	165	1155
ST37	3	155	465
ST38	13	185	2405
ST39	1	150	150
ST40	2	1 @ 190 1 @ 210	400
ST41	3	170	510
ST42	3	175	525
ST43	4	170	680
ST44	27	190	5130
ST45	1	75	75
ST46	22	190	4180
ST47	33	160	5280
ST48	4	160	640
ST49	4	160	640
ST50	16	185	2960
ST51	4	160	640
ST52	3	160	480
ST53	22	170	3740
ST54	8	160	1280
ST55	7	150	1050
ST56	18	145	2610
ST57	20	160	3200
ST58	14	160	2240
ST59	7	2 @ 145 5 @ 160	1090
ST60	14	160	2240
ST61	8	172	1376
ST62	18	245	4410
ST63	18	245	4410
ST64	2	245	490
ST65	16	190	3040
ST66	14	200	2800
ST67	5	147	735
ST68	4	205	820
ST69	4	160	640
ST70	2	145	290
ST71	8	165	1320
ST72	4	200	800
ST73	41	170	6970

FIRE DETECTION KEY	
SYMBOL	DESCRIPTION
CO2	CARBON DIOXIDE FIRE EXTINGUISHER
DP	DRY POWDER FIRE EXTINGUISHER
F	FOAM FIRE EXTINGUISHER
W	WATER BASED FIRE EXTINGUISHER
WC	WET CHEMICAL FIRE EXTINGUISHER
B	FIRE BLANKET
H	HOSE REEL
CA	FIRE ALARM CALL POINT
FR	FLASHING BEACON
SD	SMOKE DETECTOR
SDS	SMOKE DETECTOR WITH SOUNDER
HD	HEAT DETECTOR
SA	FIRE ALARM SOUNDER
MD	MAGNETIC DOOR HOLDBACK
N6	FIRE DOOR
PB	PUSH BAR FIRE EXIT DOOR

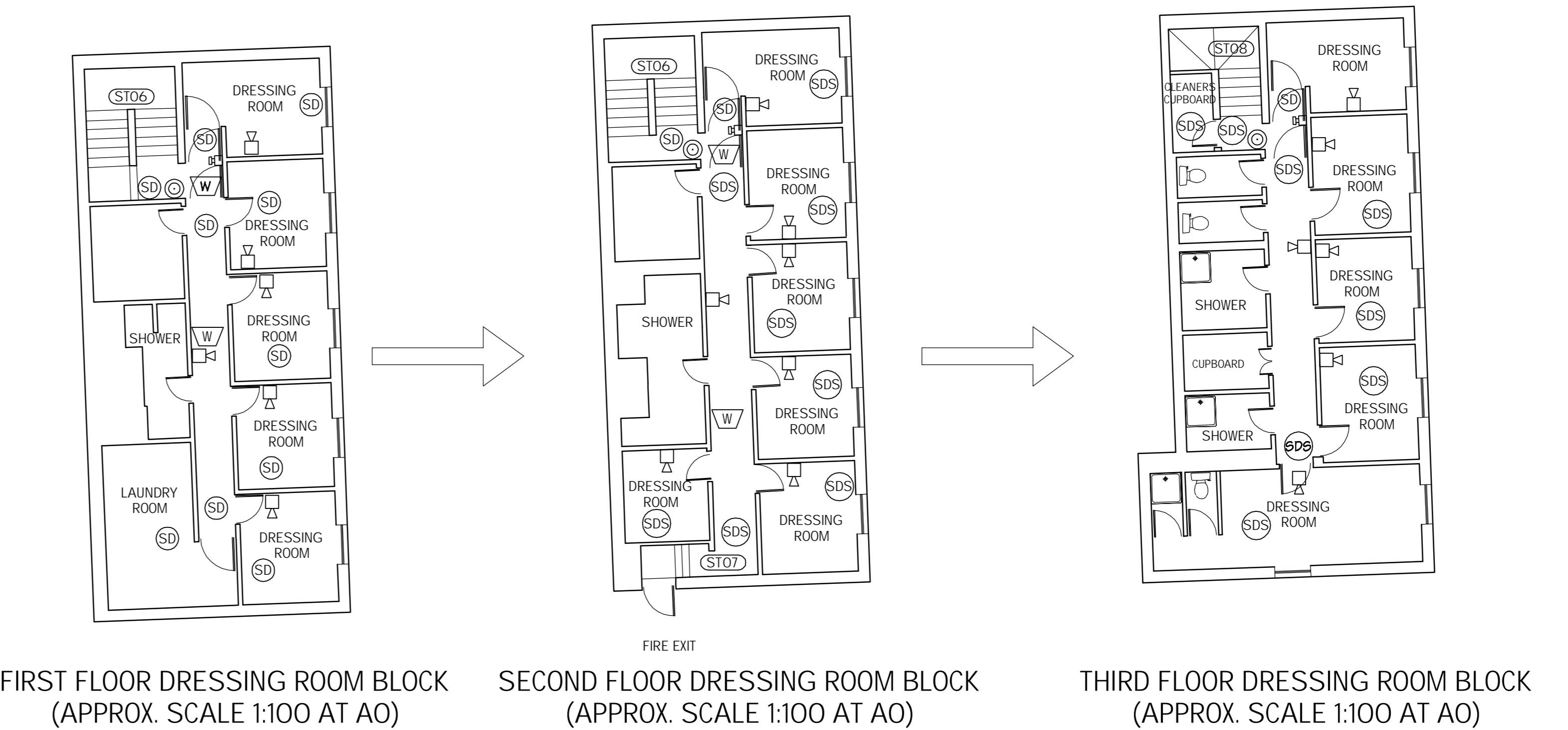
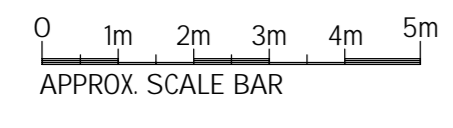
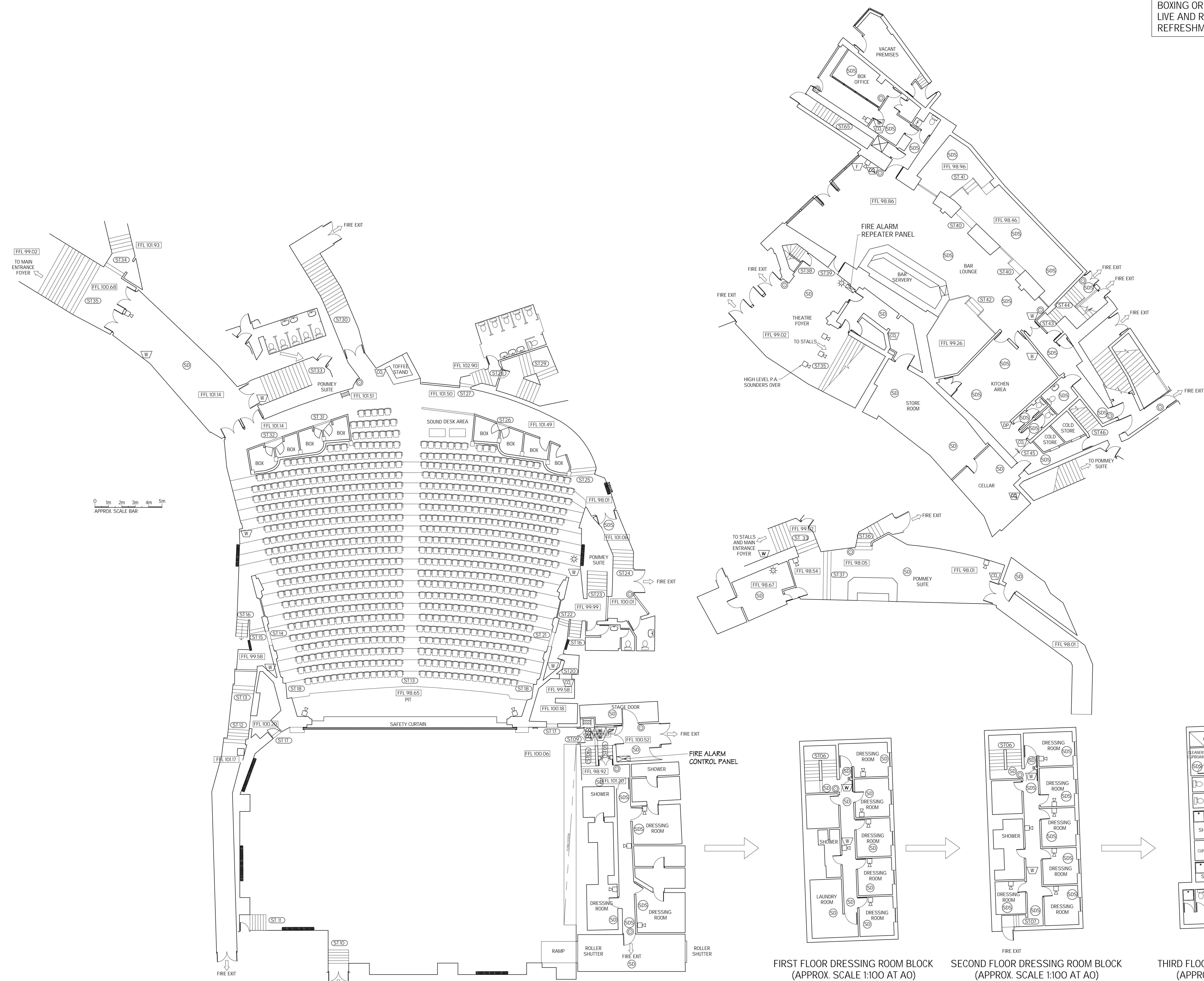

Rev.	Date	Description
Revisions		

Michael Jackson Consulting
 Chartered Structural Engineers
 25 MEMORIAL ROAD
 BRISTOL, BRISTOL, BRISTOL, BRISTOL
 Tel: 0161 790 4404
 Fax: 0161 790 4405

Client
CLEAR CHANNEL ENTERTAINMENT

Project
THE HIPPODROME THEATRE, BRISTOL

Drawing Title
STALLS LAYOUT

Scale	Date	Drawn	Checked	Issued
AS SHOWN	APR 05	MRM		

DRG. No. 1063-002

THESE PLANS ARE TO BE USED FOR LICENSING APPLICATIONS ONLY.

Notes

THESE DRAWINGS HAVE BEEN PRODUCED FROM LAYOUT DRAWINGS WHOLLY OWNED AND PROVIDED BY THE CLIENT.
 MJ CONSULTING DO NOT GUARANTEE THE ACCURACY OF THE LAYOUTS AS THE BASE DRAWINGS HAVE BEEN PREPARED BY OTHERS.
 THESE DRAWINGS ARE LAYOUT DRAWINGS ONLY TO INDICATE THE FOLLOWING INFORMATION:
 1. APPROXIMATE INDICATIVE FLOOR LAYOUTS.
 2. CERTAIN DETAILS RELATING TO FIRE DETECTION.
 3. STAIRCASE HEIGHTS.
 FL 100.06 IS THE DATUM LEVEL ON THE STAGE IN METRES. WHERE LEVELS ARE NOTED THESE ARE INDICATIVE APPROXIMATE LEVELS ABOVE OR BELOW THE DATUM LEVEL ON STAGE AT THE LINE OF THE SAFETY CURTAIN ON THE STAGE CENTERLINE.

STAIRCASE KEY			
STAIR REF	No OF RISERS	HEIGHT OF RISERS (mm)	TOTAL RISE (mm)
ST01	6	170	1020
ST02	21	245	5145
ST03	3	125	375
ST04	8	185	1480
ST05	3	170	510
ST06	33	175	5775
ST07	4	195	780
ST08	19	190	3610
ST09	2	165	330
ST10	6	190	1140
ST11	7	185	1295
ST12	5	170	850
ST13	3	205	615
ST14	2	135	270
ST15	2	145	290
ST16	14	170	2380
ST17	2	1 @ 140 1 @ 180	320
ST18	19	130	2470
ST19	22	130	2860
ST20	3	200	600
ST21	2	1 @ 140 1 @ 180	320
ST22	2	165	370
ST23	11	165	1815
ST24	6	175	1050
ST25	3	115	345
ST26	2	125	250
ST27	8	180	1440
ST28	2	1 @ 160 1 @ 145	305
ST29	72	170	12240
ST30	17	180	3060
ST31	2	160	320
ST32	2	1 @ 150 1 @ 180	330
ST33	16	160	2560
ST34	8	160	1280
ST35	11	150	1650
ST36	7	165	1155
ST37	3	155	465
ST38	13	185	2405
ST39	1	150	150
ST40	2	1 @ 190 1 @ 210	400
ST41	3	170	510
ST42	3	175	525
ST43	4	170	680
ST44	27	190	5130
ST45	1	75	75
ST46	22	190	4180
ST47	33	160	5280
ST48	4	160	640
ST49	4	160	640
ST50	16	185	2960
ST51	4	160	640
ST52	3	160	480
ST53	22	170	3740
ST54	8	160	1280
ST55	7	150	1050
ST56	18	145	2610
ST57	20	160	3200
ST58	14	160	2240
ST59	7	2 @ 145 5 @ 160	1090
ST60	14	160	2240
ST61	8	172	1376
ST62	18	245	4410
ST63	18	245	4410
ST64	2	245	490
ST65	16	190	3040
ST66	14	200	2800
ST67	5	147	735
ST68	4	205	820
ST69	4	160	640
ST70	2	145	290
ST71	8	165	1320
ST72	4	200	800
ST73	41	170	6970

FIRE DETECTION KEY	
SYMBOL	DESCRIPTION
	CARBON DIOXIDE FIRE EXTINGUISHER
	DRY POWDER FIRE EXTINGUISHER
	FOAM FIRE EXTINGUISHER
	WATER BASED FIRE EXTINGUISHER
	WET CHEMICAL FIRE EXTINGUISHER
	FIRE BLANKET
	HOSE REEL
	FIRE ALARM CALL POINT
	FLASHING BEACON
	SMOKE DETECTOR
	SMOKE DETECTOR WITH SOUNDER
	HEAT DETECTOR
	FIRE ALARM SOUNDER
	MAGNETIC DOOR HOLDBACK
	FIRE DOOR
	PUSH BAR FIRE EXIT DOOR

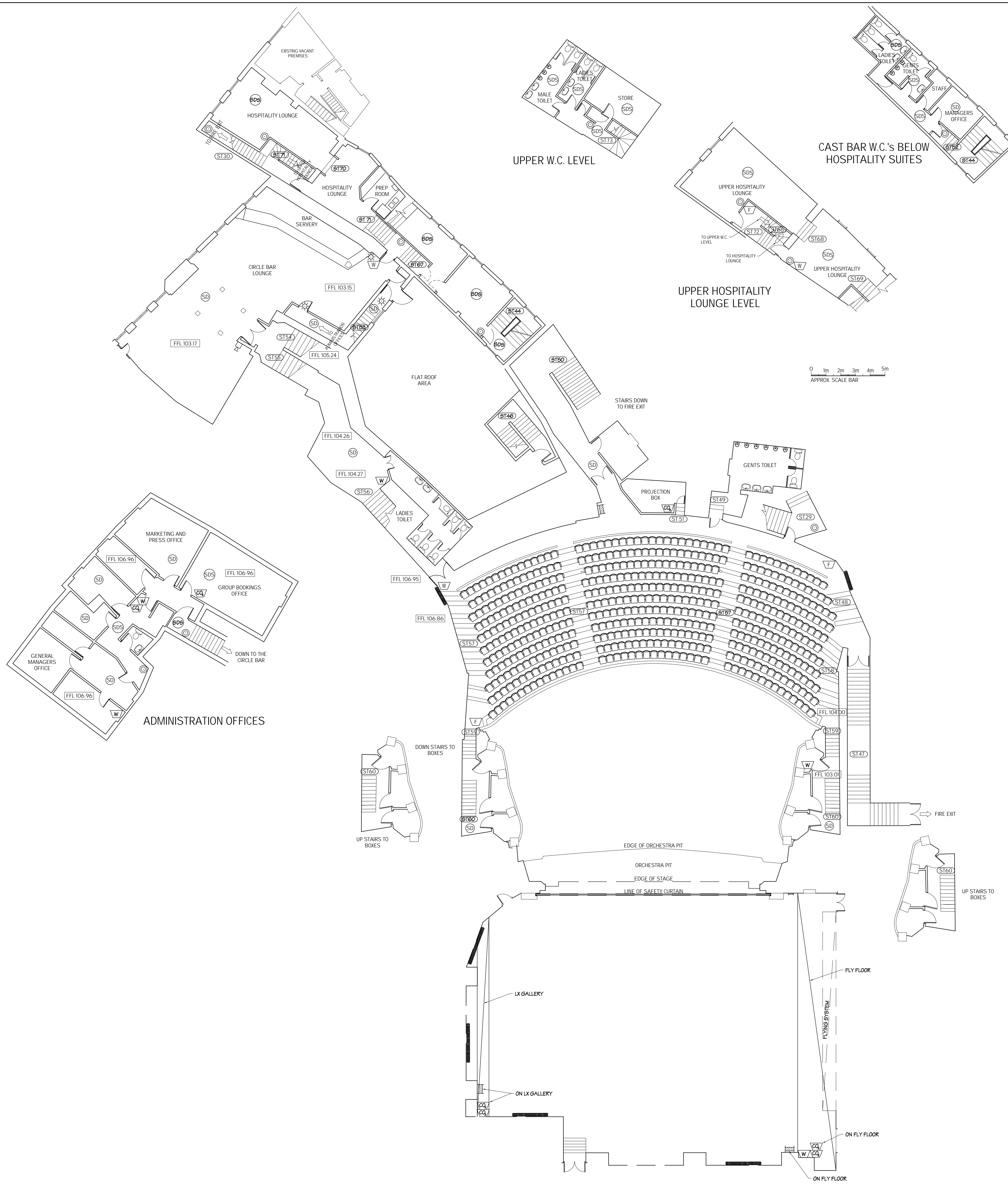

ALL PUBLIC AREAS TO BE USED FOR SALE AND CONSUMPTION OF ALCOHOL, PERFORMANCE OF PLAYS AND DANCE, PUBLIC ENTERTAINMENT INCLUDING BOXING OR WRESTLING AND PROVISION OF FACILITIES, LIVE AND RECORDED MUSIC, FILMS AND LATE NIGHT REFRESHMENT UNLESS OTHERWISE NOTED.

THESE PLANS ARE TO BE USED FOR LICENSING APPLICATIONS ONLY.

Rev.	Date	Description
Revisions		

Michael Jackson Consulting
 22 MEMORIAL ROAD
 BRISTOL, BRISTOL, BRISTOL, BRISTOL
 Tel: 0161 790 4404
 Fax: 0161 790 4405

CLEARCHANNEL ENTERTAINMENT

Client
 Project
THE HIPPODROME THEATRE, BRISTOL

Drawing Title
LOWER CIRCLE LAYOUT

Scale	Date	Drawn	Checked	Passed
AS SHOWN	APR 05	MRM		

DRG. No. **1063-003**