

HER MAJESTY'S THEATRE, LONDON.

WITH the assistance of the architect, Mr. Lee, we publish the plan of the new Opera House, and by the side of it a plan of the old one, showing, amongst other things, that a considerable addition has been made to the stage and its surroundings. The following references show the appropriation of the various parts:—

THE LATE THEATRE.

- A. Dressing-rooms.
- B. Gallery entrance, &c., stairs to amphitheatre, &c., amphitheatre stalls.
- C. Stage entrance.
- D. Housekeeper.
- E. Treasury.
- F. Manager's room.
- G. Box office.
- H. Royal entrance.
- I. Committee-room.
- J. Entrance to stage.
- K. Omnibus boxes.
- L. Stairs to flies.

THE NEW THEATRE.

- A. Stairs to amphitheatre.
- B. Stairs to amphitheatre stalls.
- C. Stairs of communication between tiers of boxes.
- D. Cheque-taker.
- E. Soldiers' room.
- F. Acting manager's room.
- G. Conductor's room.
- H. Royal entrance and stairs.
- I. Open areas.
- J. Box office.
- K. Manager's room.
- L. Treasury.
- M. Waiting-room.
- N. Stage entrance.
- O. Scenery entrance.
- P. Green-room.
- Q. Dressing-room.
- R. Stairs to stage.
- S. Stairs to dressing-rooms and carpenter's shop.
- T. Dito.
- U. Stairs to stalls.
- V. Stairs to pit.
- W. Waterclosets, &c.
- X. Stairs to pit tier of boxes.
- Y. Stairs to flies.

The dimensions of the new house run thus:—

	ft. in.
Height from pit-floor to the ceiling in the centre.....	63 0
Height from the stage to the roof over it.....	70 0
Height of basement under the stage.....	24 0
Length from back of stage to curtain.....	52 3
Length from curtain to the front of the boxes in centre.....	70 0
Diameter of curve of boxes on pit tier.....	56 0

The proscenium when finished will be 40 ft. in width, by 36 ft. in height.

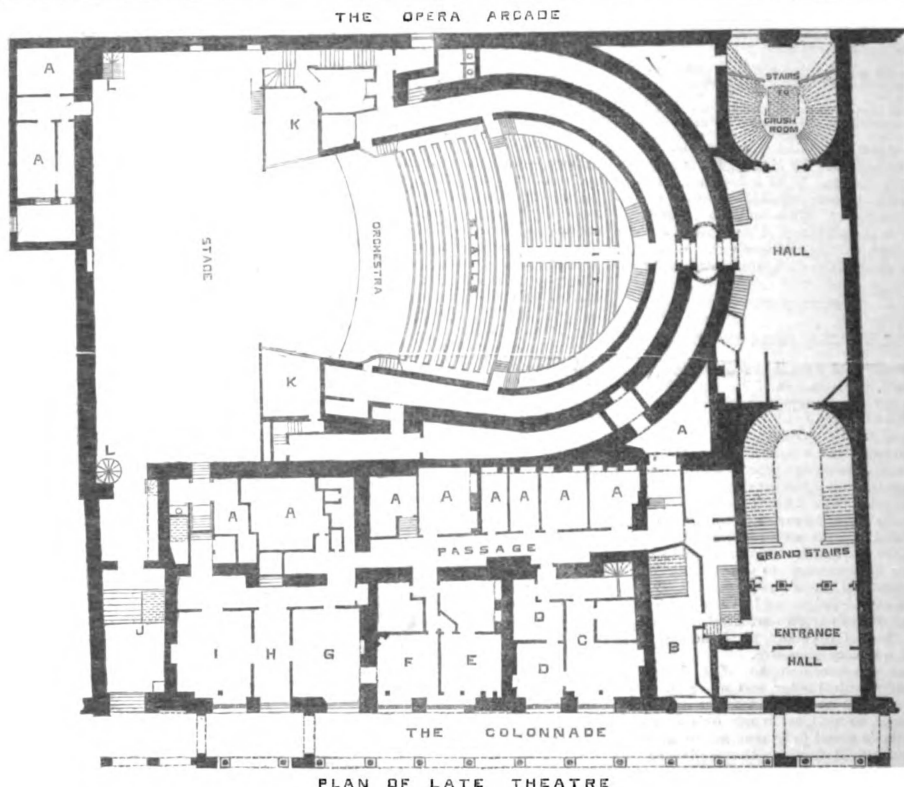

PLAN OF LATE THEATRE

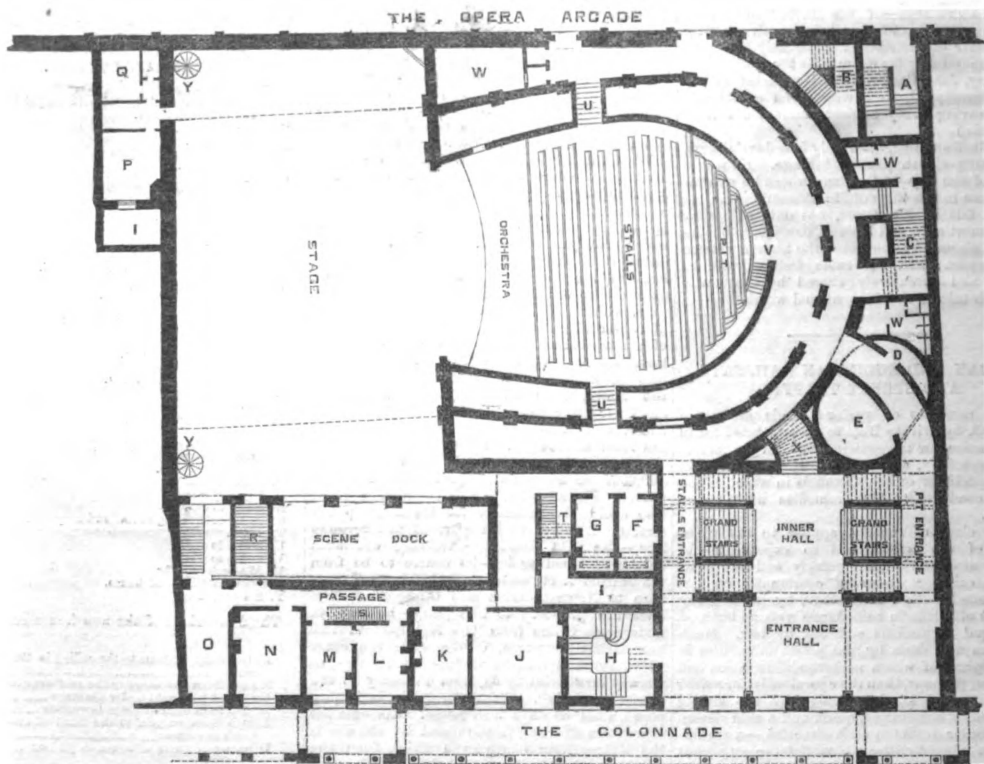

PLAN OF NEW THEATRE

SCALE OF FEET